

VICTORIAN RAILWAYS,
CASTLEMAINE AND MALDON LINE.

Scale 4 Chains to linch.

CONTRACT N^o 1651.
N^o 1^a.

C O U N T Y O F T A L B O T

P A R I S H O F C A S T L E M A I N E

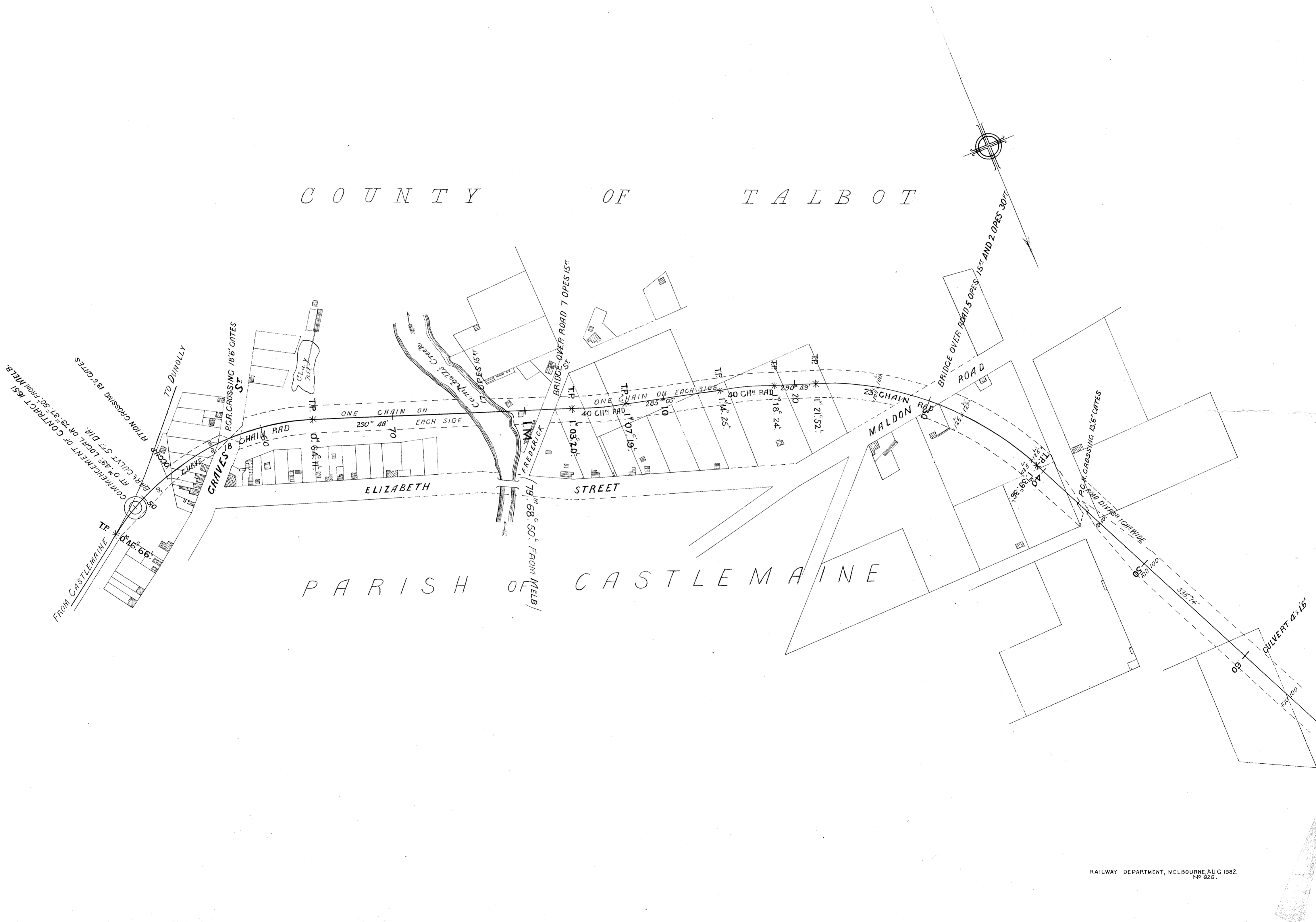

VICTORIAN RAILWAYS, CASTLEMAINE AND MALDON LINE.

Scale 10 Chains to an Inch.

CONTRACT N^o 1651.
N^o 3.

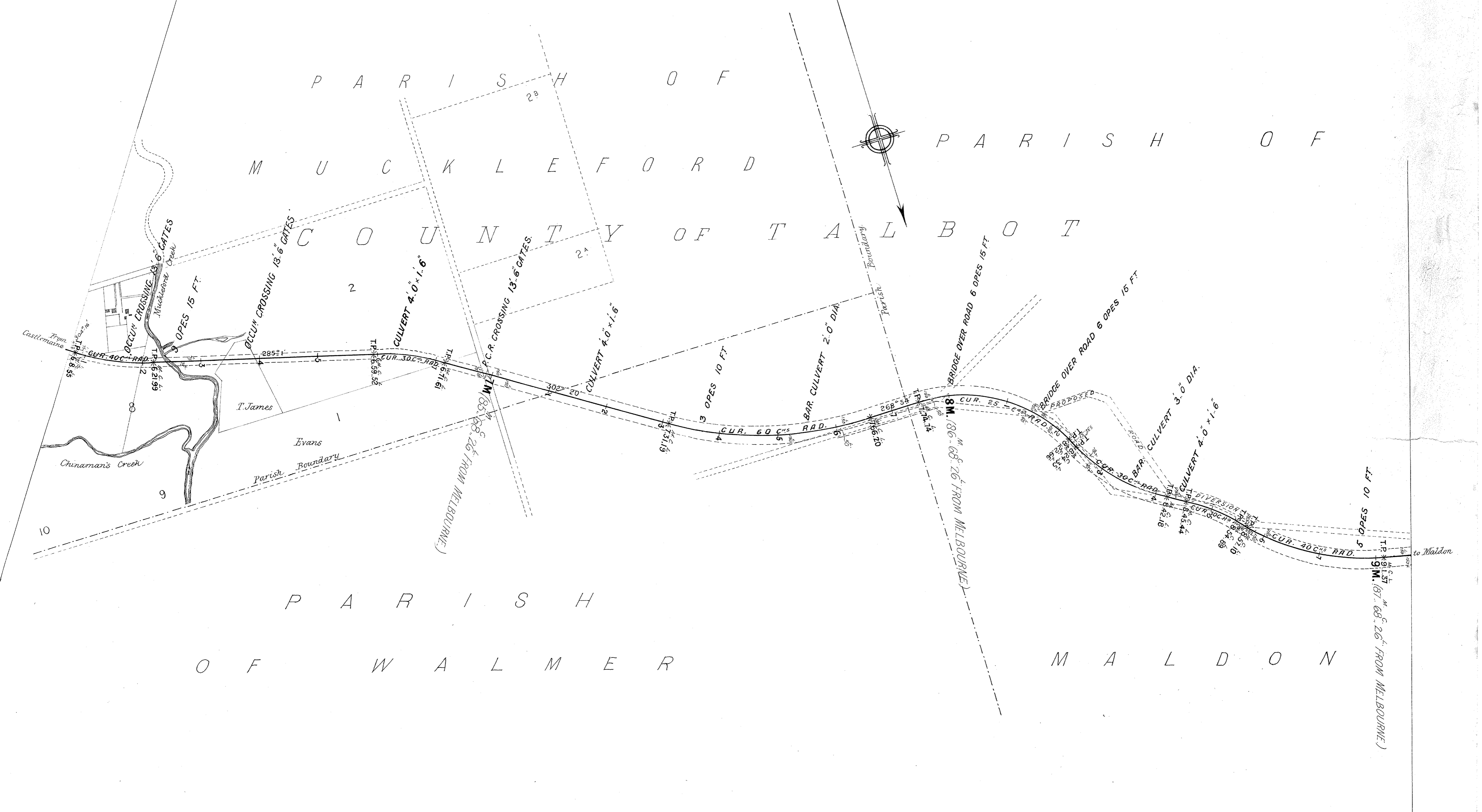

VICTORIAN RAILWAYS, CASTLEMAINE AND MALDON LINE.

Scale 10 Chains to 1 inch.

CONTRACT N^o 1651.
N^o 4.

C O U N T Y O F T A L B O T



P A R I S H O F M A L D O N

VICTORIAN RAILWAYS, CASTLEMAINE AND MALDON LINE.

Scale 4 Chains to 1 inch.

CONTRACT N^o 1651.
N^o 4^A.

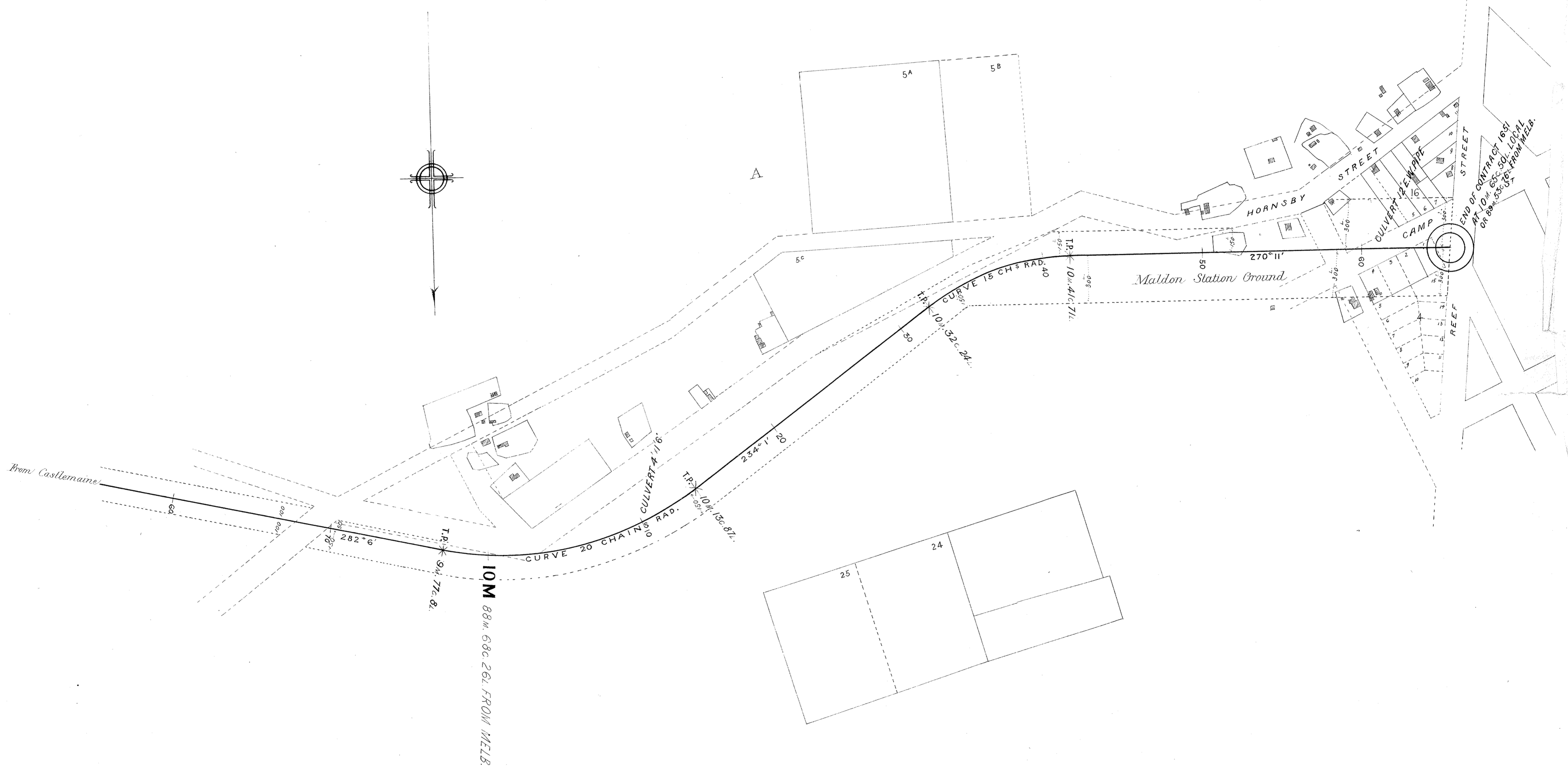

VICTORIAN RAILWAYS, CASTLEMAINE AND MALDON LINE.

CONTRACT N^o 1651.
N^o 1.

SCALES. HORIZONTAL 4 CHAINS TO AN INCH.
VERTICAL 40 FEET TO AN INCH.

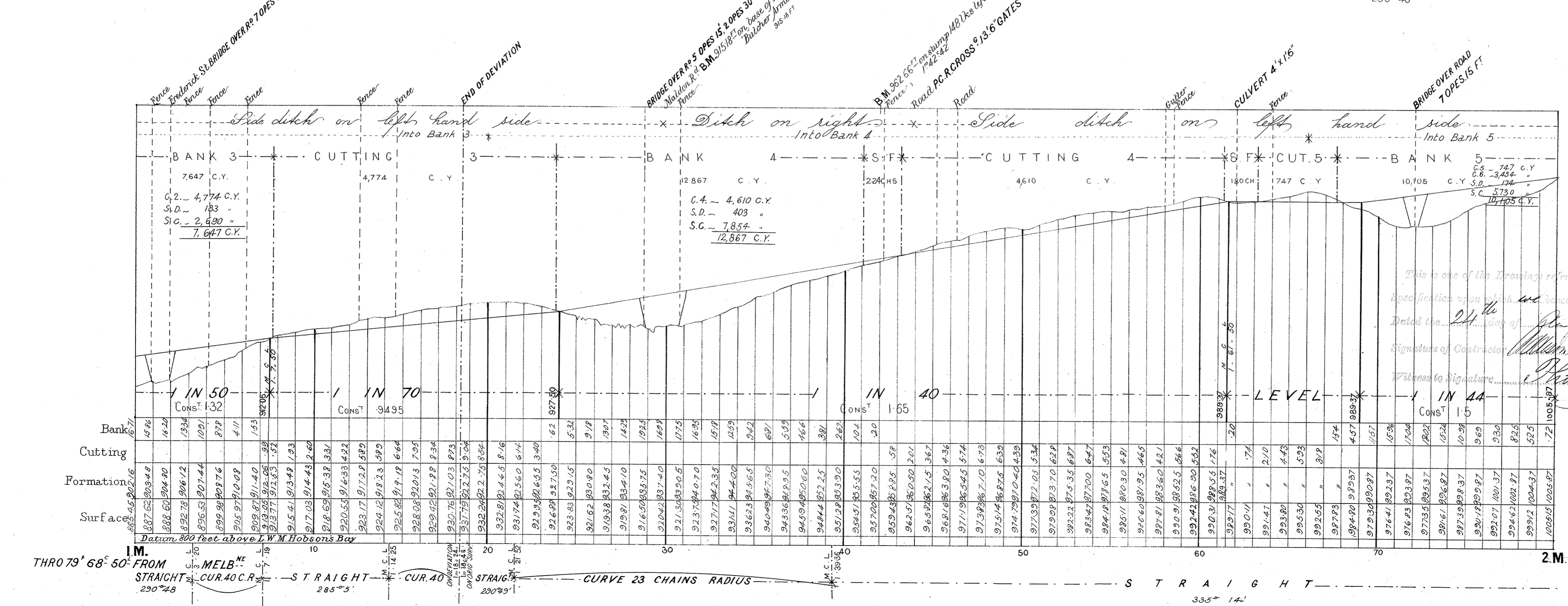
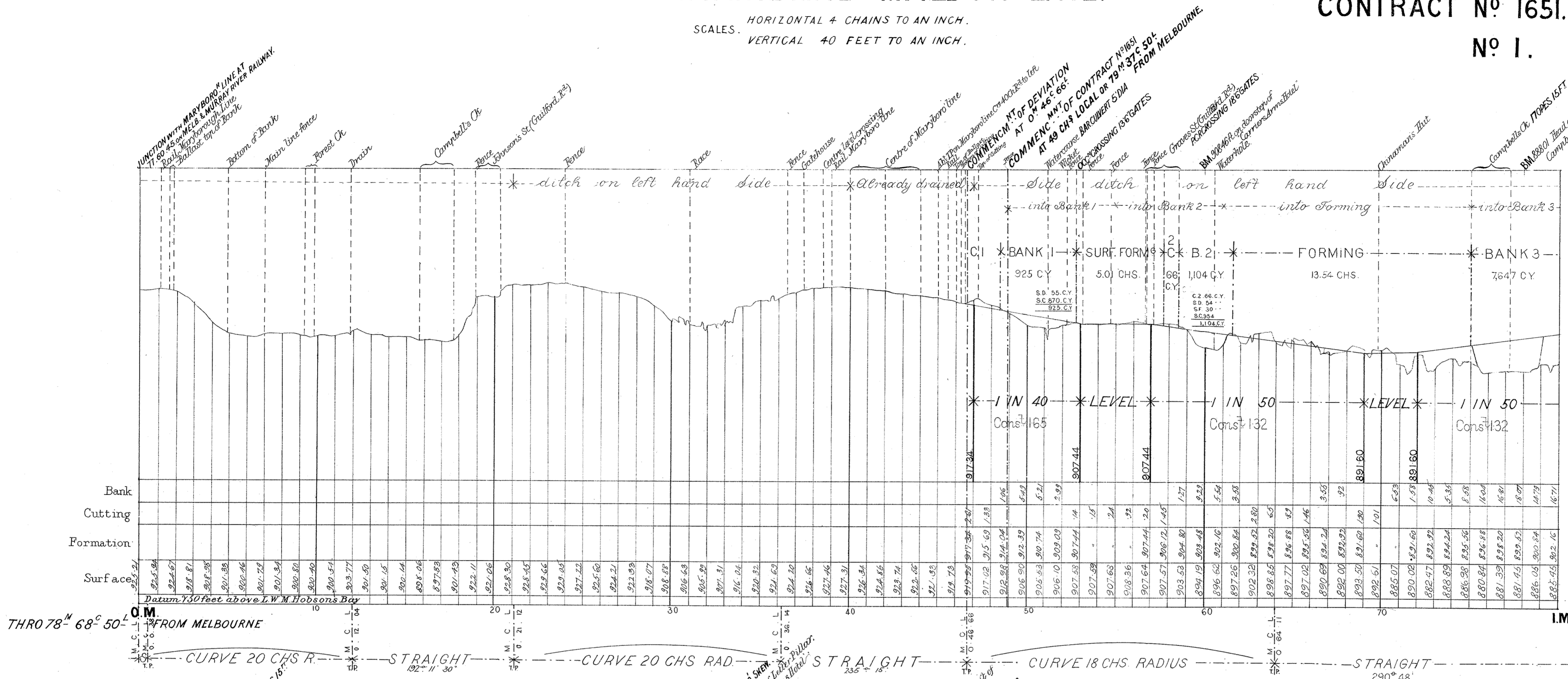

This is one of the Drawings referred to in the
Specification of work on which the contract was
dated the 24th day of August 1882
Signature of Contractor *Wm. Pearce & Co*
Witness to Signature *J. H. Pearce*

VICTORIAN RAILWAYS, CASTLEMAINE AND MALDON LINE.

CONTRACT N^o 1651.

HORIZONTAL 4 CHAINS TO AN INCH.
VERTICAL 40 FEET TO AN INCH.

N^o 2.

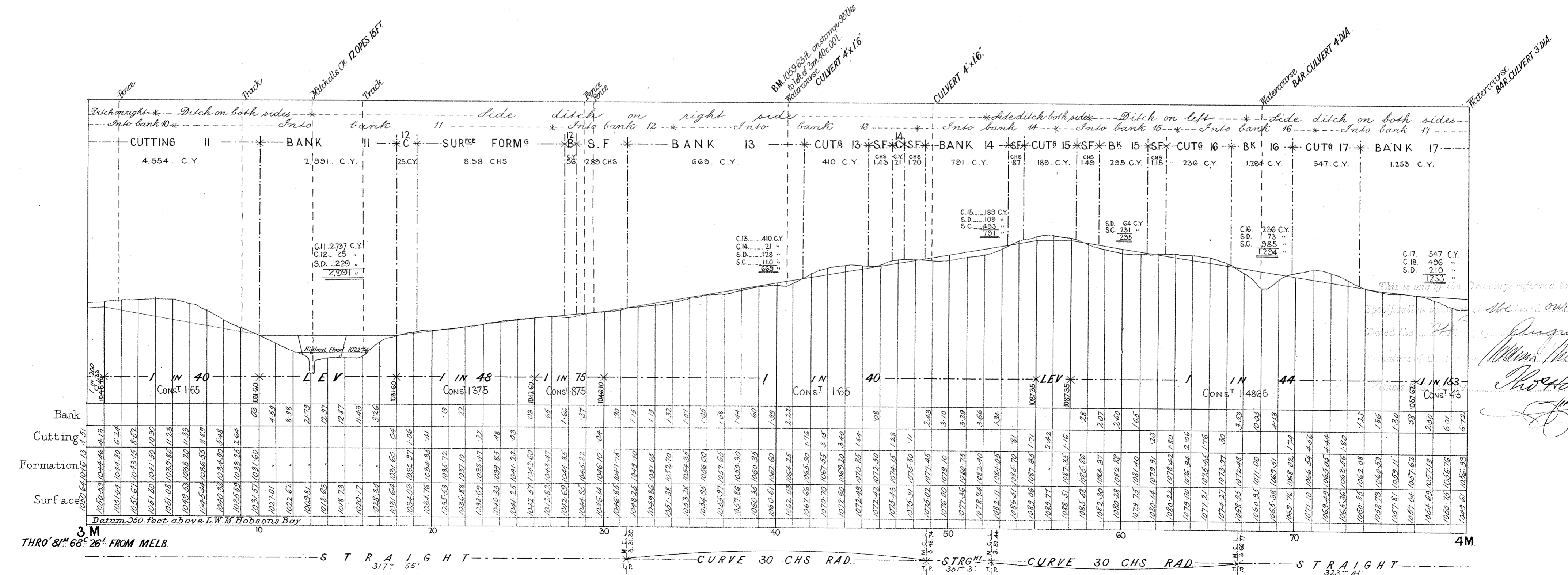
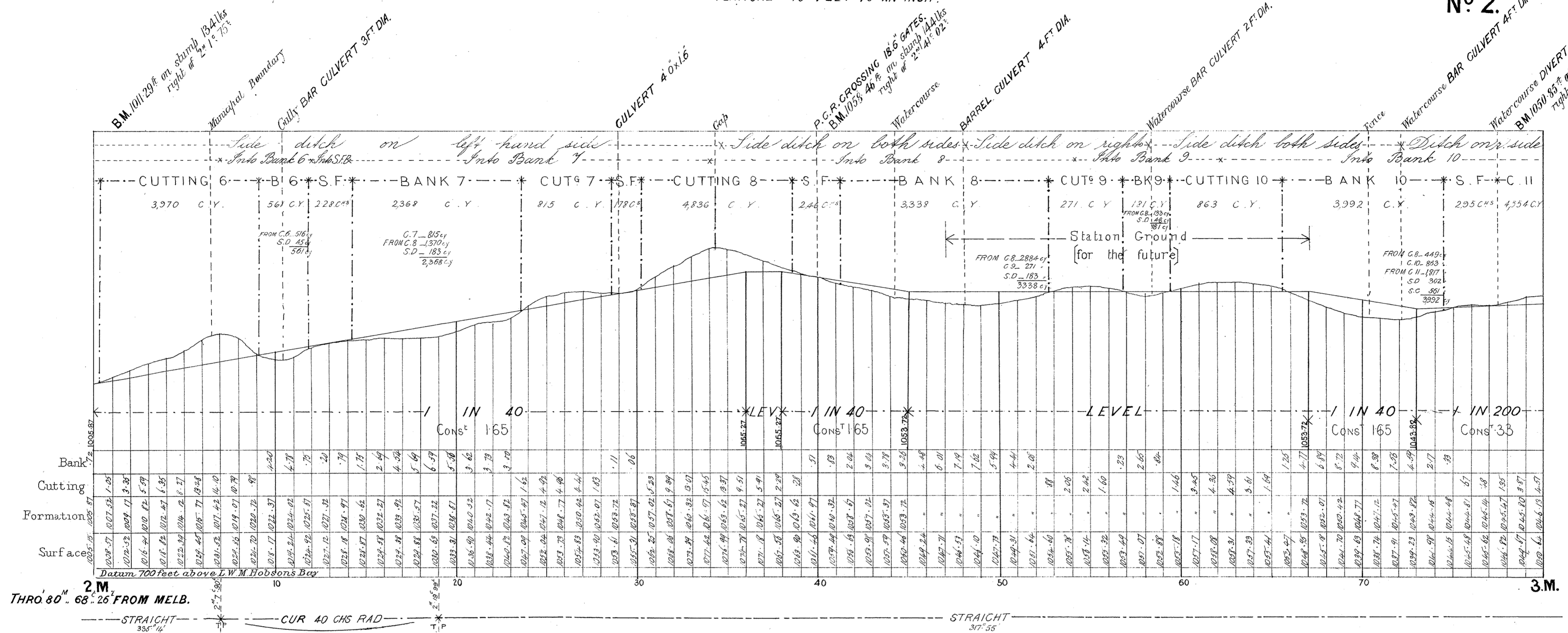

This is one of the drawings referred to in the Specifications of the above contract and under Dated the 21st August 1882
William Mitchell Esq
Engineer

VICTORIAN RAILWAYS, CASTLEMAINE AND MALDON LINE.

CONTRACT N^o 165I.
N^o 4.

SCALES.
HORIZONTAL 4 CHAINS TO AN INCH.
VERTICAL 40 FEET TO AN INCH.

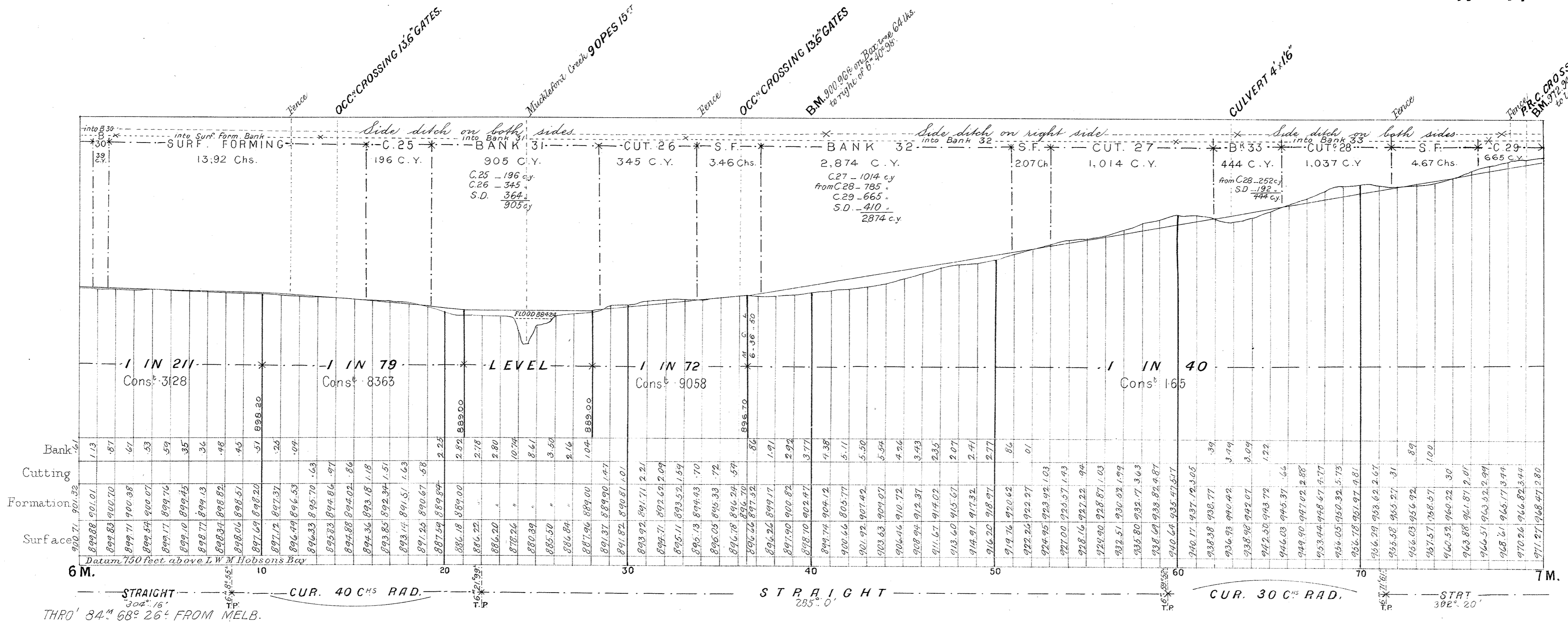

THRO' 84° 68' 26" FROM MELB.

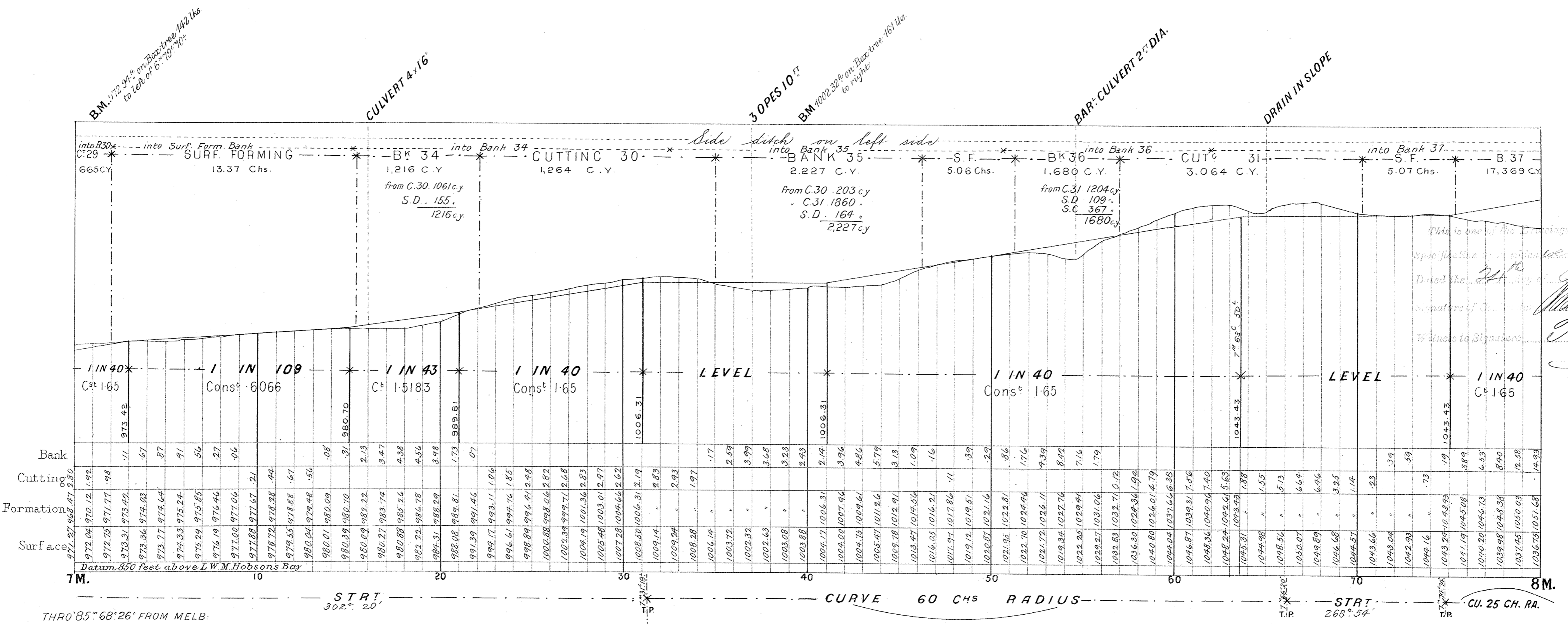

THRO' 85° 68' 26" FROM MELB.

This is one of the drawings referred to in the
Specification of the above-named Contract
Dated the 21st day of August 1882
Signature of Contracting Officer
Wm. Mitchell
Witness to Signature
Thos. Howe

VICTORIAN RAILWAYS, CASTLEMAINE AND MALDON LINE

CONTRACT NO 1651
NO 5.

SCALES. HORIZONTAL 4 CHAINS TO AN INCH.
VERTICAL 40 FEET TO AN INCH.

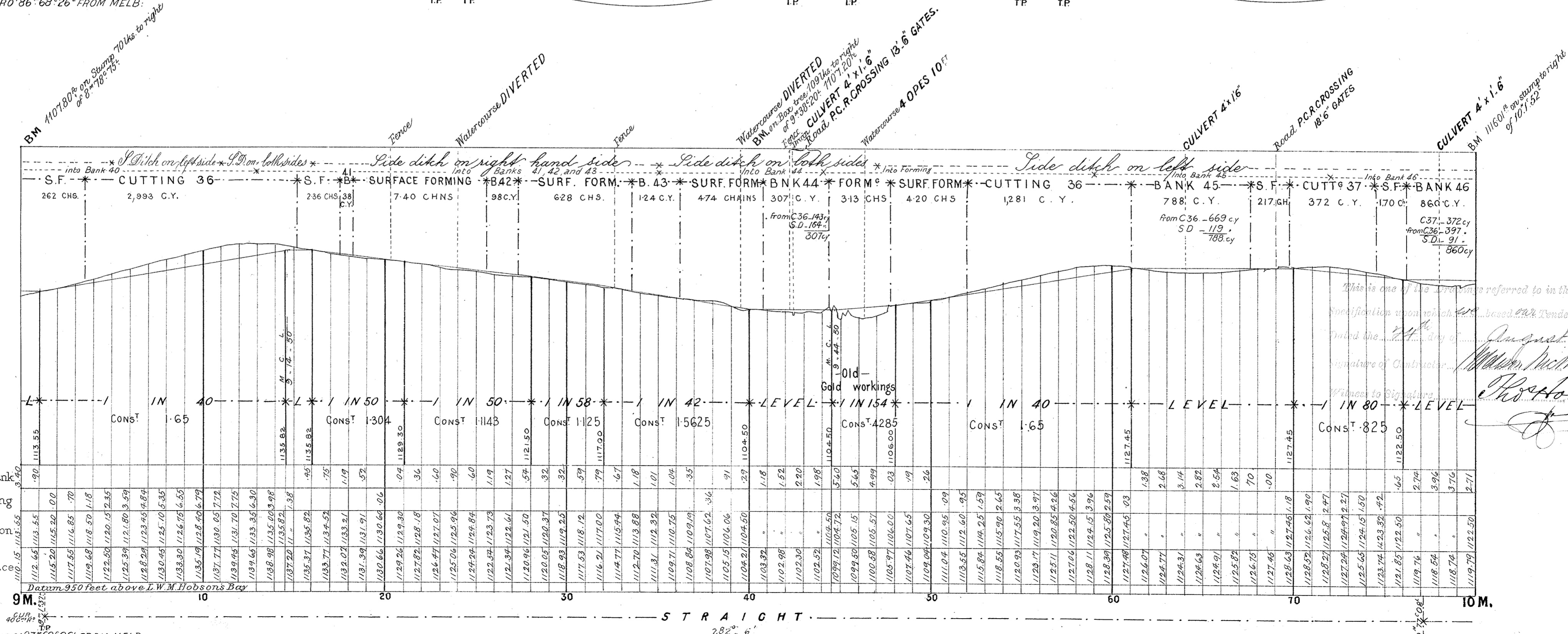
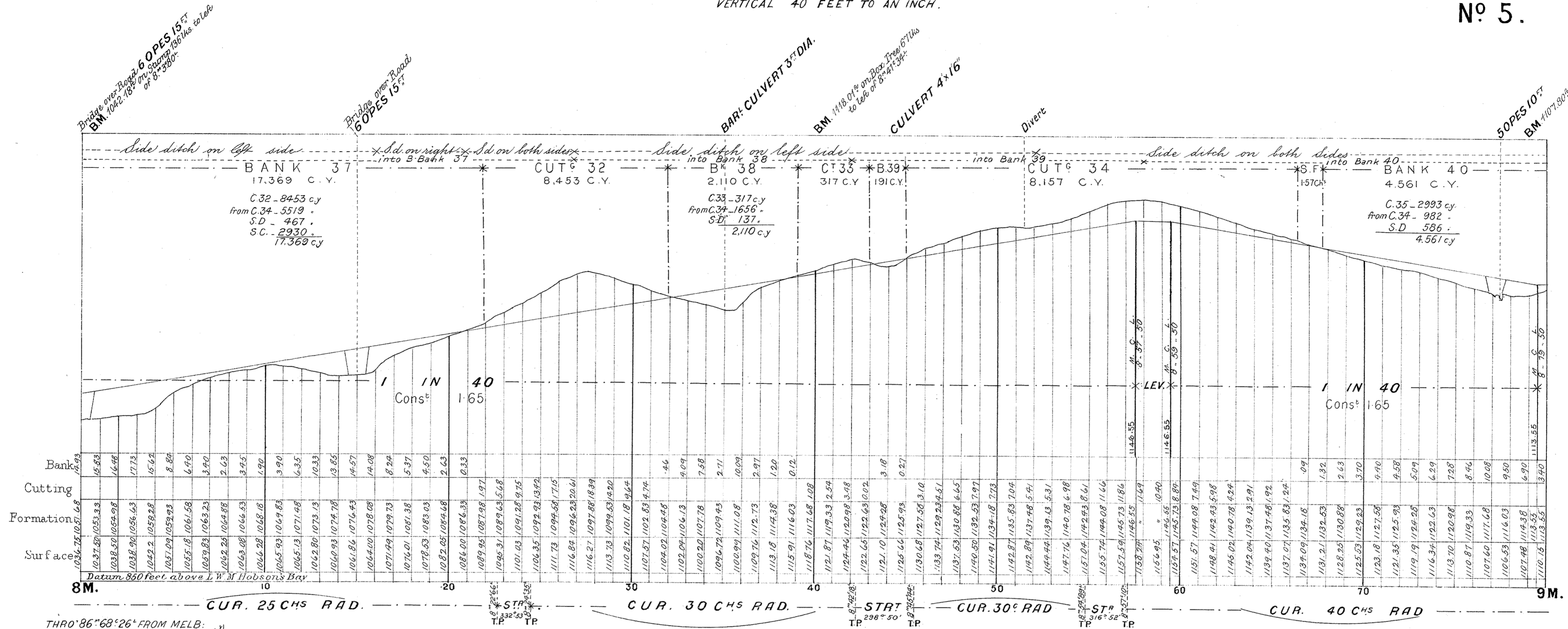

This is one of the drawings referred to in the
Specification upon which was based the Tender
made on the 11th day of August 1882
and the signature of Contract is
Witness to Signatures
Thos Hoare

VICTORIAN RAILWAYS, CASTLEMAINE AND MALDON LINE.

CONTRACT NO 165I.
NO 6.

HORIZONTAL 4 CHAINS TO AN INCH.
VERTICAL 40 FEET TO AN INCH.

